

Selection and Ordering data

Pointek Specials. See note 1.

CLS100 Polycarbonate Lid and Gasket, FKM

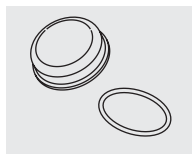

Kit, Lid and gasket, CLS100 enclosure version **A5E01163671**

CLS100 Miscellaneous Parts

Custom length of cable is available only for 7ML5501-xxx1x and 7ML5501-xxx5x **See note 2.**

CLS200 Gasket (IP65), Synprene



Spare gasket, enclosure version (IP65 versions only) **A5E01163672**

CLS200 Gasket (IP68), Silicone

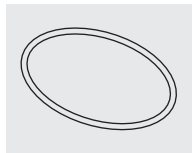

Spare gasket, enclosure version (IP68 versions) **A5E01163673**

CLS200 Blind Lid



Spare aluminum blind lid (for standard versions only) **A5E01163674**

CLS200 Lid with window

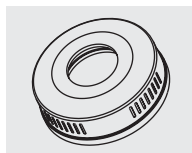

Spare aluminum lid with window **A5E01163676**

CLS200 Sensor Kit for cable units



Kit, Sensor for cable units, PPS, Standard, FKM **A5E01163677**

Kit, Sensor for cable units, PPS, Digital, FKM **A5E01163678**

Kit, Sensor for cable units, PPS, Standard, FFKM **A5E01163679**

Kit, Sensor for cable units, PPS, Digital, FFKM **A5E01163680**

Kit, Sensor for cable units, PVDF, Standard, FKM **A5E01163681**

Kit, Sensor for cable units, PVDF, Digital, FKM **A5E01163682**

Kit, Sensor for cable units, PVDF, Standard, FFKM **A5E01163683**

Kit, Sensor for cable units, PVDF, Digital, FFKM **A5E01163684**

CLS200 Mounting Bracket, 316L stainless steel

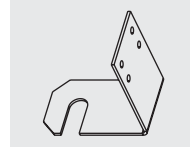

Spare mounting bracket **A5E01163685**

CLS200 PROFIBUS Connector (IP65)



Spare, PROFIBUS connector (IP65 versions only) **A5E01163686**

CLS200 Miscellaneous Parts

CLS200 with FFKM O-rings (any version) **See note 2.**

CLS300 Cable Extensions, 316L stainless steel

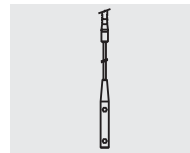

Kit, Stainless steel cable extension, 1 m (3.28 ft), adjustable by customer **A5E01163688**

Kit, Stainless steel cable extension, 3 m (9.8 ft), adjustable by customer **A5E01163689**

Kit, Stainless steel cable extension, 5 m (16.4 ft), adjustable by customer **A5E01163690**

Kit, Stainless steel cable extension, 10 m (32.8 ft), adjustable by customer **A5E01163691**

Kit, Stainless steel cable extension, 15 m (49.2 ft), adjustable by customer **A5E01163693**

Kit, Stainless steel cable extension, 20 m (65.6 ft), adjustable by customer **A5E01163695**

CLS300 Cable Extensions, 316 stainless steel with PFA coating

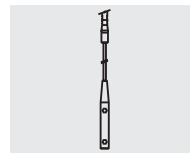

Kit, PFA cable extension, 1 m (3.28 ft), adjustable by customer **A5E01163697**

Kit, PFA cable extension, 3 m (9.8 ft), adjustable by customer **A5E01163698**

Kit, PFA cable extension, 5 m (16.4 ft), adjustable by customer **A5E01163699**

Kit, PFA cable extension, 10 m (32.8 ft), adjustable by customer **A5E01163700**

Kit, PFA cable extension, 15 m (49.2 ft), adjustable by customer **A5E01163701**

Kit, PFA cable extension, 20 m (65.6 ft), adjustable by customer **A5E01163702**

CLS300 Rod Kits, 316L stainless steel

Kit, Stainless steel rod 180 mm (7.09") to be used with CLS300 units only (with standard active shield). Insertion length after installation is 350 mm (13.78").

A5E01163719

Kit, Stainless steel rod 330 mm (12.99") to be used with CLS300 units only (with standard active shield). Insertion length after installation is 500 mm (19.69").

A5E01163720

Kit, Stainless steel rod 580 mm (22.83") to be used with CLS300 units only (with standard active shield). Insertion length after installation is 750 mm (29.53").

A5E01163721

Kit, Stainless steel rod 830 mm (32.68") to be used with CLS300 units only (with standard active shield). Insertion length after installation is 1000 mm (39.37").

A5E01163722

Kit, Stainless steel rod 1330 mm (52.36") to be used with CLS300 units only (with standard active shield). Insertion length after installation is 1500 mm (59.06").

See note 2.

Kit, Stainless steel rod 1830 mm (72.05") to be used with CLS300 units only (with standard active shield). Insertion length after installation is 2000 mm (78.74").

See note 2.

Kit, Stainless steel rod customized length up to 1 m

See note 2.

Kit, Stainless steel rod customized length up to 2 m

See note 2.**CLS300 Electronics Kits with drivers (for rod or cable versions)**

Kit, Electronics with driver, standard CLS300. To be used in rod or cable versions with length less than 5 m. See note 3 and 4.

A5E01163723

Kit, Electronics with driver, digital CLS300. To be used in rod or cable versions with length less than 5 m. See note 3 and 4.

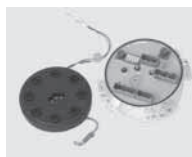
A5E01163725**CLS300 Electronics Kits with drivers (for cable versions)**

Kit, Electronics with driver, standard CLS300. To be used in cable versions with length greater than 5 m. See note 3 and 4.

A5E01163724

Kit, Electronics with driver, digital CLS300. To be used in cable versions with length greater than 5 m. See note 3 and 4.

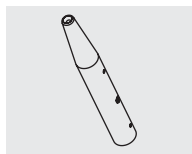
A5E01163726**CLS300 Weight Kit, 316L stainless steel**

Kit, Spare stainless steel weight. To be used in any cable version of CLS300

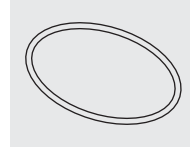
A5E01163727**CLS500 Gasket (IP65), Silicone**

Spare gasket, CLS500 enclosure version, IP65

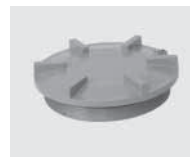
A5E01163728**CLS500 Blind Lid**

Spare CLS500 aluminum blind lid

A5E01163729

Note 1: Special flange sizes and facings are available. Please contact nacc.smpi@siemens.com for part number and pricing. Submit Application Questionnaire found on page 5/8.

Note 2: Please contact nacc.smpi@siemens.com for part number and pricing.

Note 3: For General Purpose approvals only.

Note 4: To maintain approvals, qualified trained Siemens personnel required for part replacement.

Please contact nacc.smpi@siemens.com for special requests.